

2 D SCAN HEAD

# PSH-30

en | Data sheet | 1.1.1

- Premium 2-axis laser scan head / 30 mm
- Highest precision with minimal drift
- Laser power up to 1000 Watt, CW 1064
- Designed for demanding laser applications



Wavelength	1064 nm <sup>[1]</sup>	Long-term-drift per axis (8 h)	80 µrad
Input beam diameter	30 mm	Cooling method	Passive
Tracking delay	0,45 ms	Control interface	XY2-100-Standard
Writing speed	280 cps <sup>[2]</sup>	Humidity	80% <sup>[3]</sup>
Marking speed	1,2 m/s	Supply voltage DC	15 V
Max. optical deflection	0,35 rad	Current consumption	10 A
Resolution	12 µrad	Operation temperature	15 – 35 °C
Repeatability (RMS)	2 µrad	Storage temperature	-35 – 60 °C
Positioning noise (RMS)	2 µrad	Mechanical dimensions (W × D × H)	152 × 206.9 × 180 mm
Max. gain-drift per axis	20 ppm/K	Net weight	6,6 kg
Max. offset-drift per axis	20 µrad/K		

<sup>[1]</sup> Other available wavelengths: 10600 nm

<sup>[2]</sup> f=163 / Hight 1 mm

<sup>[3]</sup> Non condensing



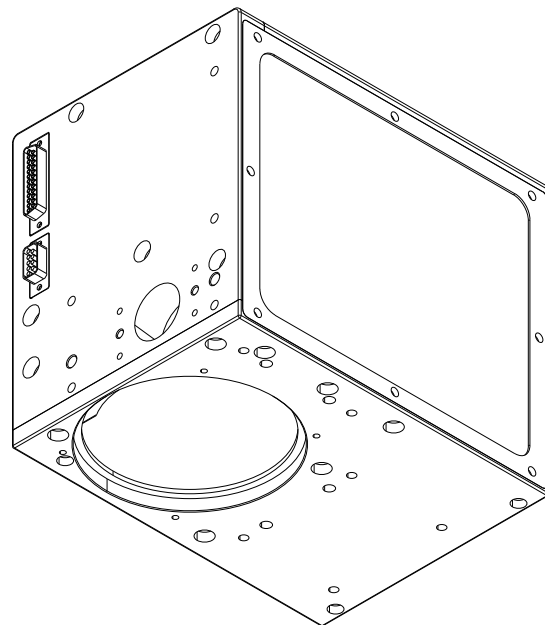
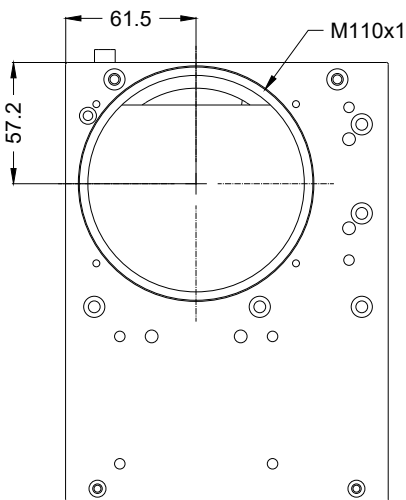
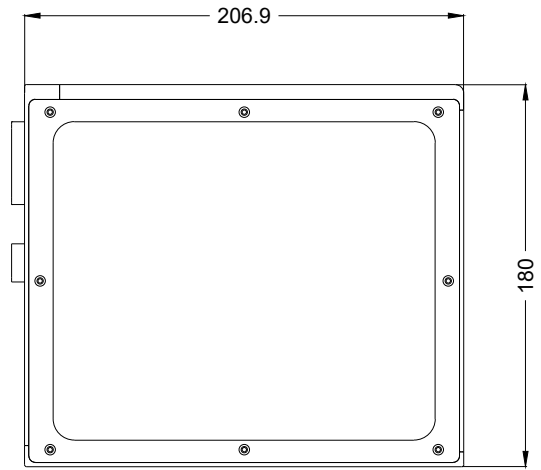
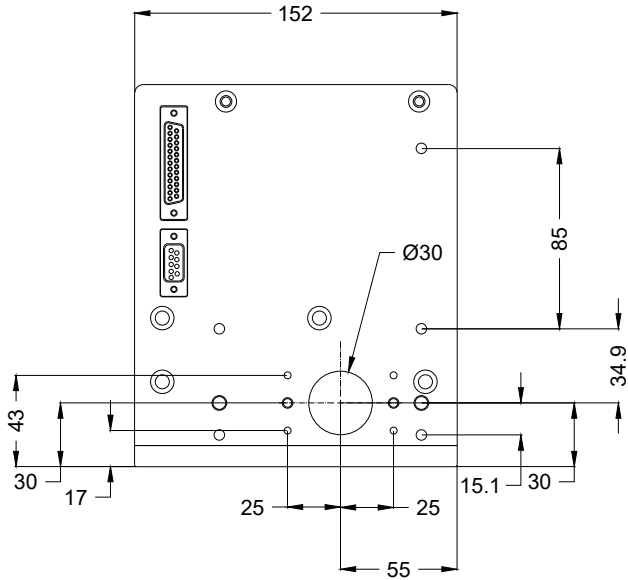

2D scan head

PSH-30

Dimensions are given in millimeters and are intended as reference values.  
Binding information is available on request.

